

SMART GATEWAY  
USER GUIDE

ZIGBEE



Product Configuration

With Ethernet Port

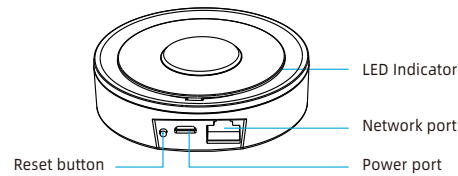

No Ethernet Port

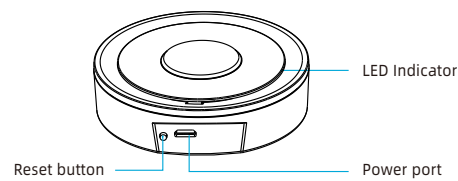

Feature & Specifications

Support Zigbee 3.0 protocol to add Zigbee subsystem  
App remote control  
USB power: 5V/1A  
Working temperature: 0-55°C  
Working humidity: 10%-90%RU  
Comprehensive number of work: 5,000  
Wireless frequency: 2.4GHz  
Communication protocol: Zigbee 3.0  
Network protocol: Zigbee IEEE 802.15.4  
Frequency band: 2.4 ~ 2.485GHz  
Maximum output power: 19dBm  
Network topology: support star, tree, mesh network  
Firmware upgrade: OTA Support  
WAN:RJ45, 10 / 100M Ethernet ports(Wired gateway only)  
Size: 78mm x 78mm x 25mm

LED State

| Device Status | LED State                       |
|---------------|---------------------------------|
| Pairing mode  | Indicator flashes 2times/second |
| Reset         | Long press for 6s               |

**Note:**  
1. Please reset the device before you add it;  
2. No quantity limits to add the device.  
3. The phone and gateway have to connect network with same router before adding the device;

Network Settings

1. Power on the gateway;
2. Confirm configuration indicator on;
3. Ensure your phone connect with home 2.4GHz frequency band router, meanwhile the phone and gateway are in same LAN;

Get Started

- 1. Download APP**  
Download the "Smart life" app from APP Store or Google Play to your mobile.



- 2. Register and Login**  
A.Launch the "Smart life" app.  
B.To register,enter your mobile phone number or email address,create a password ,then login to the app.  
C.Login if you have an account already.

Add ZigBee Controller

Add Tuya ZigBee controller first and operate with the controller user manual.(Pls notice the wired and wireless version controller)

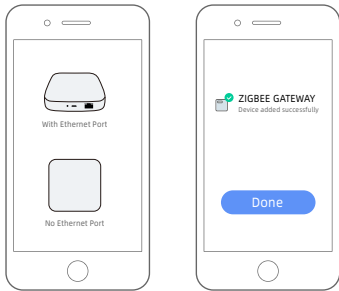

Note: The diagram is for reference only. (UI maybe different in other APP version)

Add Sub-device

Add the ZigBee Sub-device.(Reset first before configuration)

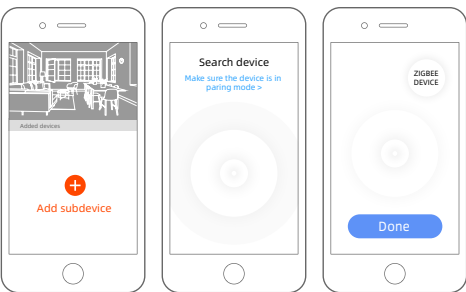

Note: The diagram is for reference only. (UI maybe different in other APP version)

Main User Interface



Note: The diagram is for reference only. (UI maybe different in other APP version)

Advanced Features

You can experience the various advanced features of the device with the app, just try and do it yourself.

**Add subdevice**  
Support to add Zigbee sub device: Motion sensor, Door sensor, Siren alarm, Water sensor, Power plug...

OTHER FUCTION

- Linkage scene**  
Allow others to control the device
- Device sharing**  
Allow others to control the device
- Push notification**  
(1)Device push; When the push is disable, message records still exist, but push messages will not be received.  
(2)All APP push; If push is disabled, all devices in the APP will not push notification, but message records will not be affected.
- Remove device**  
Restore default settings:Hold Press the button (> 6 seconds), the distribution network indicator light becomes often bright.
- Firmware upgrade**  
Support for remote automatic upgrade and App selection upgrade;



Smart Home Device contains WiFi smart device,Z-Wave device and ZigBee device,give you more choices to create a new smart life.

Wide application on the living room, kitchen, bedroom,bath-room, garage, garden, yard or basement of your home,of-fice,warehouse,chain store...

Make life smarter and more convenient.

