

# Manual Instruction

## Bluetooth Mesh LED Controller Model No.: C31BT/C51BT

Please read the instructions carefully before using the controller.

### 1. Features

Bluetooth Mesh LED Controller is our newly developed high-ed controller, controlled by Tuya Smart Life APP directly, also 3G/4G long distance control and support third party voice control (need Tuya Bluetooth Mesh Gateway).

- 16 Millions of colors to choose
- Bluetooth wireless control
- Color temperature 2700K~6500K
- Smartphone APP control
- Dim brightness / saturation
- Support third party voice control (need Tuya Bluetooth Mesh Gateway)
- Support music rhythm
- Support remote control (control distance 30m)
- Support scene customization
- Device sharing
- Timing setting /countdown turn on /off LED light
- Group control
- Tap-to-Run & automation
- 2.4G wireless transmission technology
- PWM Frequency Switching
- Auto-transmitting & Synchronizatiinn
- Overheating protection
- Link/Unlink/Reset Button on the controller

### 2. Parameters

Model No.: C31BT  
Input Voltage: DC12V~24V(5.5\*2.1mm)  
Output: 6A/Channel (Total Output Max: 15A)  
Working Temperature: -25~40°C  
Size: 74.5\*35.6\*16.5mm  
Output Mode: RGB / RGBW / RGB CCT  
RF: 2.4GHz RF Control Distance: 30M

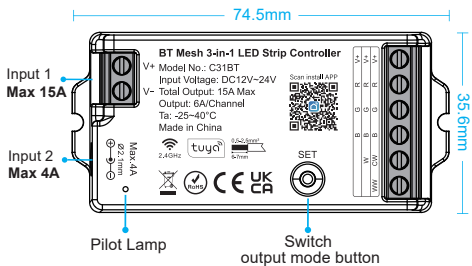

Model No.: C51BT  
Input Voltage: DC12V~24V(5.5\*2.1mm)  
Output: 6A/Channel (Total Output Max: 15A)  
Working Temperature: -25~40°C  
Size: 74.5\*35.6\*16.5mm  
Output Mode: Single Color / CCT / RGB / RGBW / RGB CCT  
RF: 2.4GHz RF Control Distance: 30M

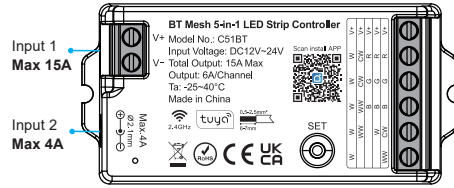

### Smart Link&Unlink: We have 3 methods to Link and Unlink to APP.

- Long press " SET " 3 seconds, the purple will blink 3 times, the device go into Smart Link/Unlink mode.
- Use Linked 091 remote, long press the linked Zone ON button for 3 seconds, the purple light will blink 3 time, the device go into Smart Link and Unlink Mode.
- Switch ON and OFF 4 times(OFF-ON-OFF-ON-OFF-ON-OFF-ON) within 10 seconds, the purple light will blink 3 time, the device go into Smart Link and Unlink Mode.

**Note:** Pilot lamp red light always ON means device not link to APP, need to do above steps to link. green light always ON means device linked to APP; device is controllable.

### 3. Switch output mode

Press the " SET " key briefly. The indicator lights in different colors will flash to represent different output modes, as detailed in the table below.

	White Light Flickering	Yellow Light Flickering	Red Light Flickering	Green Light Flickering	Blue Light Flickering
C031BT	\	\	RGB Mode	RGBW Mode	RGB+CCT Mode (Default Mode)
C051BT	Single Color Mode	Dual White Mode	RGB Mode	RGBW Mode	RGB+CCT Mode (Default Mode)

### 4. Signal transmitting

One strip controller can transmit the signals from the remote control to another controller within 30m, as long as there is a strip controller within 30m, the remote control distance can be limitless.

### 5. Auto-transmitting Diagram

One strip controller can transmit the signals from the remote control to another controller within 30m, as long as there is a strip controller within 30m, the remote control distance can be limitless.

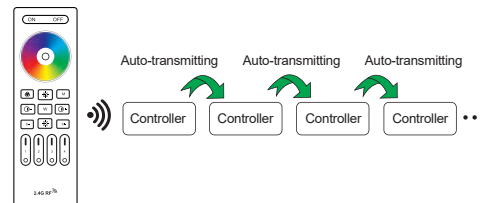

## 6. remote dynamic mode

Dynamic mode controlled by remote control		
Dynamic mode No.	mode	Compatible Models
1	Seven color jumps: red, orange, yellow, green, cyan, blue, purple	RGB CCT LED Controllers
2	Seven color gradients: Red, Orange, Yellow, Green, Cyan, Blue, Purple.	
3	Six color breathing changes: Red, Yellow, Green, Cyan, Blue, Purple.	
4	Colorful 360-degree cyclic gradient.	RGBW LED Controllers
5	Colorful random jump change	
6	Red to yellow gradient	RGB LED Controllers
7	Cyan to Blue gradient	
8	red to purple gradient	
9	green to cyan gradient	

\*The Single color and CCT LED controller does not support the dynamic mode of the remote control.

### 7.3. Connect to RGB LED strip diagram

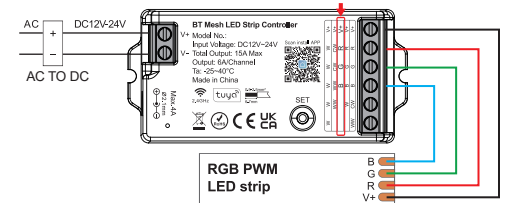

### 7.4. Connect to RGBW LED strip diagram

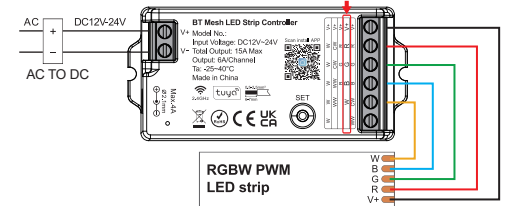

### 7.5. Connect to RGB+CCT LED strip diagram

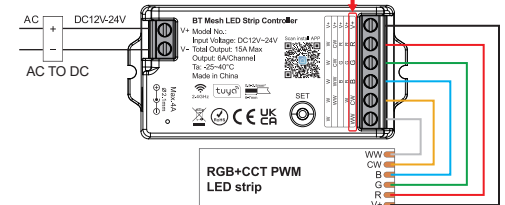

## 7. Connect to LED strip

**!** The controller should be installed as close to the power supply as possible. In particular, when the current exceeds 10A, the wiring length between the power supply and the controller must not exceed 1 meter.

### 7.1. Connect to Single Color LED strip diagram

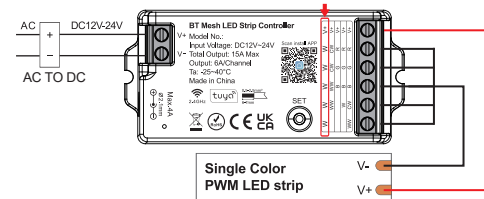

### 7.2. Connect to CCT LED strip diagram

(Note: For CCT mode, total output current is 12A max.)

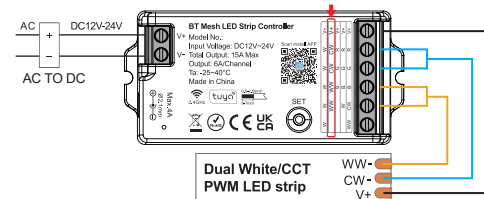

## 8. Remote Controller

Compatible with these remote controls (Purchased separately). For more details, pls read the remote instruction.

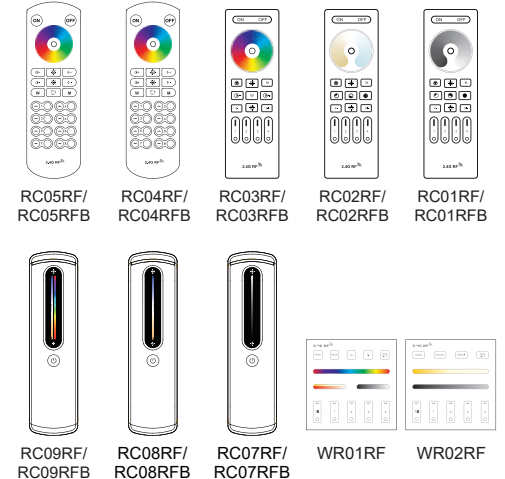

## 9. Bluetooth Mesh APP Control Instruction

### 9.1. Download and install [Tuya Smart] APP or [Smart Life] APP:

Search for [Smart Life] in Apple or Google store or scan following QR code to download and install the app.

Please click "Register" button to create account while using it in the first time, Log in directly if you already had account.



### 9.2. Connect to Smartphone

- (1). Set up Bluetooth function on your smartphone.
- (2). Power the controller, when the light ON, Long press "SET" Button, when the pink light blink, the light come into smart link mode.
- (3). Open the log-in Smart Life APP, it will auto find the device.

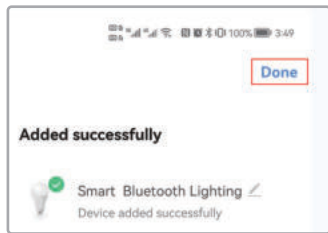

- (4). Added device will be displayed on the homepage after added successfully, then Click device you want to control to enter the control interface.



## 10. APP Control

(1).Once entering the APP control interface:

**Color:** Adjust color, saturation and brightness as needed.

**White:** Customize color temperature and brightness for precise white light tuning.

**Scene:** Select from preset dynamic lighting effects or create your own DIY modes.

**Music:** Activate music-sync lighting to match beats in real time.

See the illustration below.



Color

White

Scene

Music

- (2).Click "⌘" go into "Countdown off" function setting.

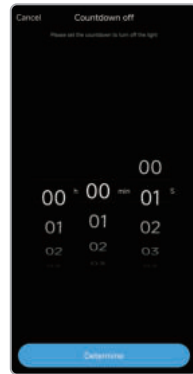

- (3). Click "⊞" go into more functions setting like Plan, Default Light, Do Not Disturb and Switch Gradient. See below pictures:

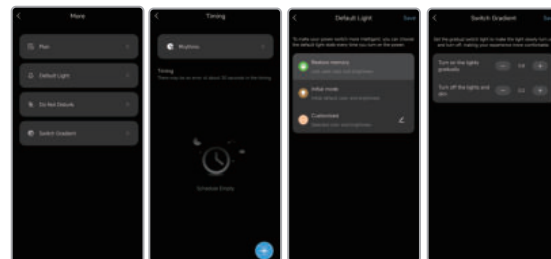

**Note:** To set up Timer function, you need to link Bluetooth Mesh Gateway.

- Do not disturb function, pls read below pics carefully.

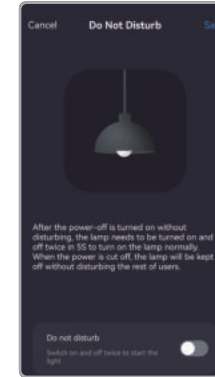

## 11. Device name editing, Third-party Control, Device Sharing and Group Control.

- (1). Click [⋮] on the top right corner of control page to come into extra function.
- (2). Click icon under third-party control to view detailed description of third-party control(need Bluetooth Mesh Gateway).
- (3). Click [Share Device] to share the device to family and friends. (need Bluetooth Mesh gateway).

**Note:** to share device, you need to create a home first, then add members in to this home. Please read 6th instructions for how to make home management.

- (4). Click "Create Group" and follow APP prompt after setting is completed, the devices can be controlled by group.

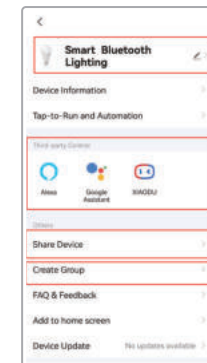

## 12. How to make Home Management for DeviceSharing.

- (1). Click [⊞] on the home page control interface, then click Me [Home Management] to enter Home management making.

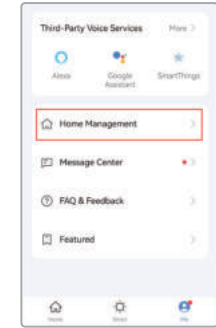

- (2).Click [Create a home] to complete home management, then you can add members on the home, and share device to your home number.

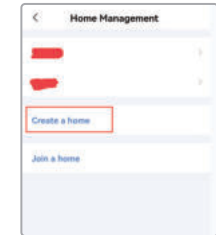

**Note:** Bluetooth Gateway connection, please read the manual instruction after you buy the bluetooth gateway.

### ⚠ Attention

1. Please check whether the input voltage of the constant voltage power supply is in accordance with the controller, and please check the connection of both the cathode and anode.
2. The working Voltage is DC12~24V, the controller will be broken if the voltage is higher than 24V.
3. Non-professional user cannot dismantle the controller directly, otherwise, it may cause fire and electric shock.
4. The working temperature is -25~40°C; Do not use the device to direct sunlight, moist and other high temperature area.
5. Please do not use controller around the mental area and high magnetic field, otherwise, it will badly affect the control distance.
6. When the device load to 12A, wire diameter must be over 1.5mm<sup>2</sup>.
7. The light automatically turns off during operation and then automatically turns back on after a while. This indicates that the overheating protection has been triggered. Please reduce the load power.



Made in China